



Double Din
Android Car Radio

User Manual

Technical Support Email
hikitySupports@163.com

<https://thehikity.com>

Content

【Tips And Warnings】	1
【Important Tips】	1
【Test】	1
【Installation】	2
【Wiring Connections】	3
1. Harness.....	3
2. Diagram of reversing camera wiring.....	6
【Introduction of Basic Functions】	7
1. Main interface.....	7
2. Main Menu Operation.....	7
3. System Settings.....	8
4. Bluetooth.....	19
5. Local Music.....	22
6. Local Radio.....	22
7. Net Navi.....	22
8. Video.....	23
9. TIMA.....	23
10. ANDROID LINK menu.....	24
11. IPHONELINK menu.....	24
12. Screen floating bar.....	24
13. Panel button control light.....	25
14. Offline Map.....	25
【Simple Trouble Shooting】	27
1>Unable to boot normally.....	27
2>Automatic shut-down.....	27
3>When booting up, only the Android logo is displayed and it is stuck and cannot be used.....	28

4>Noise.....	28
5>The equalizer is set, the sound cannot be adjusted.....	28
6>No sound after installation.....	28
7>After a while there is no sound.....	29
8>The sound of the car's microphone is very small, and the other party can't hear the Bluetooth call.....	29
9>Only the radio has sound, other modes (Bluetooth, USB) have no sound	29
10>BT call the other party can hear the sound, but I can't hear.....	30
11>Bluetooth not working.....	30
12>Navigation APP can not be accessed, no sound, screen delay, inaccurate positioning, stuck and cannot be used, etc.....	31
13> FM can't find radio.....	31
14>Does not support reversing image.....	31
15>GPS, Voice, Language, Offline Maps only in English and Chinese.....	32
16>The button light does not light up.....	32
17>Clock still showing after shutdown.....	33
18>Remove the original car's radio.....	33
19>Unable to save settings (No memory).....	33
20>How to turn off PODOFO+ little robot Floating Icon.....	33
21>Install the Navigation antenna.....	33
22>USB flash drive does not read (Optional)	33
23>The product emits smoke.....	34
24>Machine reset.....	34
25>Steering wheel button learning.....	34
26>Screen button light is on, but the screen black.....	35
27>Touch screen and button not work.....	35

[Tips And Warnings]

In order to emphasize the important information of the user manual, special attention should be paid when seeing the label  which indicates some important warnings and reminders.

[Important Tips]

Please read all instructions before installation, it is recommended that the machine be installed by a car audio professional.

 This machine is suitable for vehicle 12V power supply system (grounding wire is required), please do not install this machine in 24V vehicle, otherwise it will damage the machine.

 Do not repair the power fuse without professional guidance. Improper use of the fuse can cause damage to the machine or cause a fire.

 To avoid violating traffic rules, drivers cannot watch videos while driving and operating machines to avoid unnecessary accidents.

 For the sake of safety and to ensure the normal use of the product, please invite professionals to install, disassemble or repair the machine to avoid machine damage and accidents.

 Please avoid placing this product in a humid environment and water to avoid fire due to electric shock or other unnecessary damage.

Note: To prevent burning out the machine, please do not energize until you have connected the power cord correctly

[Test]

A quick simple test before the installation is to confirm that the device is working normally and as expected. In case there is a wrong step in the subsequent installation, which causes it to fail to work. If you perform a successful test but the unit did not work after installing it please recheck the installation steps.

Test car stereo: ① The red and yellow wires of the car stereo combine together firstly and then connected to the positive pole of the 12V battery, ② The black wire is connected to the negative pole of the

battery. ③ 2 seconds later, check the car stereo, if the screen is lighting up, it means the car stereo is proper functioning.

[Installation]

If your car's center console is large, you can install the 10.1-inch large-screen radio into the mounting hole.

If your car's center console is small, you can use a hanging installation to hang the 10.1-inch large-screen radio before the car's center console. There is no need to embed it in the mounting hole.

Product Size (Including screen edge): 5.6 in * 9.9 in / 14.2 cm * 25.2 cm)

Minimum Installation Size: 7.0 in * 4.0 in * 2.0 in / 17.8 cm * 10.2 cm * 4.9 cm (2 DIN / 12V).

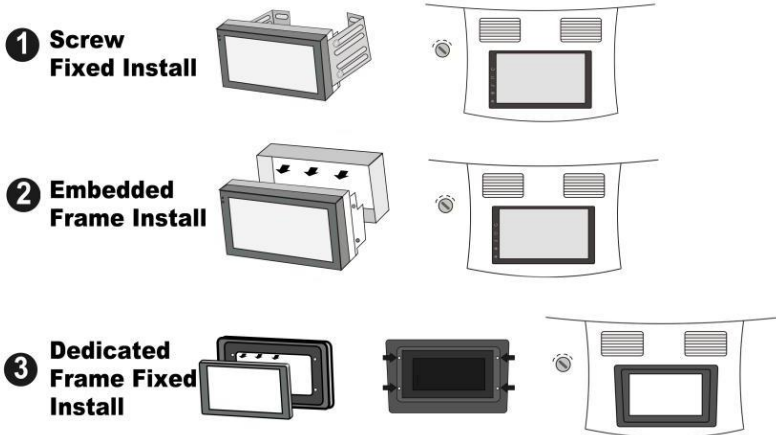

As shown in the figure above, there are three ways to install the machine, please choose one of them according to the actual situation. Of course, you can also re-install the new radio according to the installation method of the original car radio.

Note: this model came with 4 pieces screws and 2 pieces brackets, doesn't include the frame and installation kit, if you need it, please buy extra

[Wiring Connections]

Firstly, for different producing time, wires' color may be different, so please refer for their function according to the label taped on wires.

Except for power cables (red, yellow and black), other function cables don't have to connect unless you need that functions. If you don't need this function, you can just cover the metal part by insulating tape. They won't effect daily using.

1. Harness

1.1 16pin (power cable)

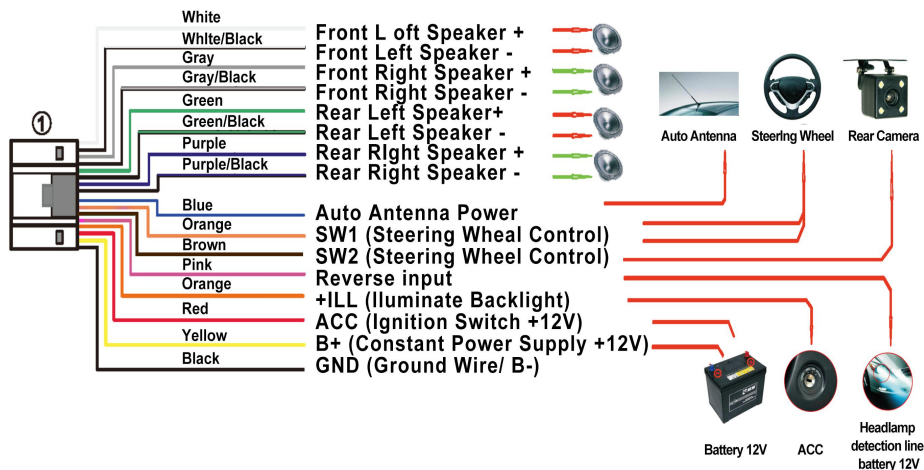

1.2 20pin (Audio and Video Output Port)

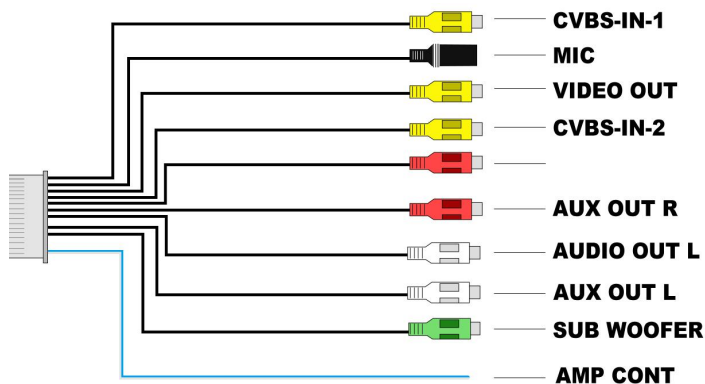

If you are using your own amplifier, please check its power cables wiring:

Positive to car's ACC, negative to battery negative

You don't need to connect it to this car radio's "radio antenna control wire" and "AMP control" .

Then the amp will be turned on once your car is on, and work with

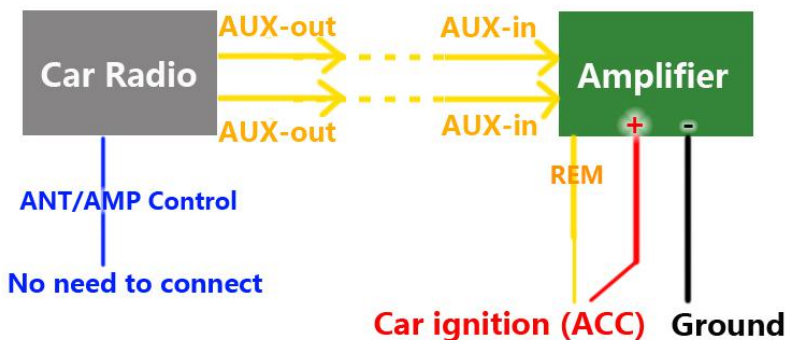

1.3 4pin USB-1、 6pin USB-2



4 Pin USB Cable



6 Pin USB Cable

1.4 10pin BREAK1.BACK_CVBSIFI/BT

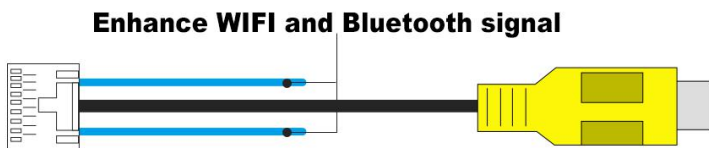

Reversing input

NOTE: Whether you are using a rear view camera or not, please connect the rear view wire. Otherwise, your WiFi and Bluetooth signals will suffer.

2. Diagram of reversing camera wiring

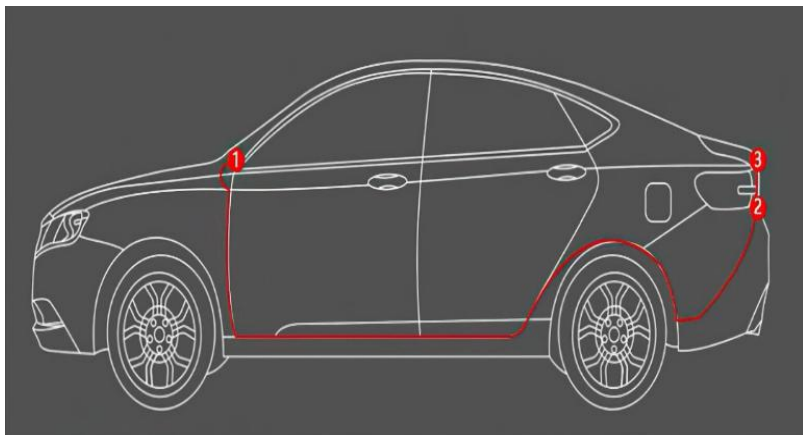

1. Car Radio
2. Camera Power Source
3. Camera

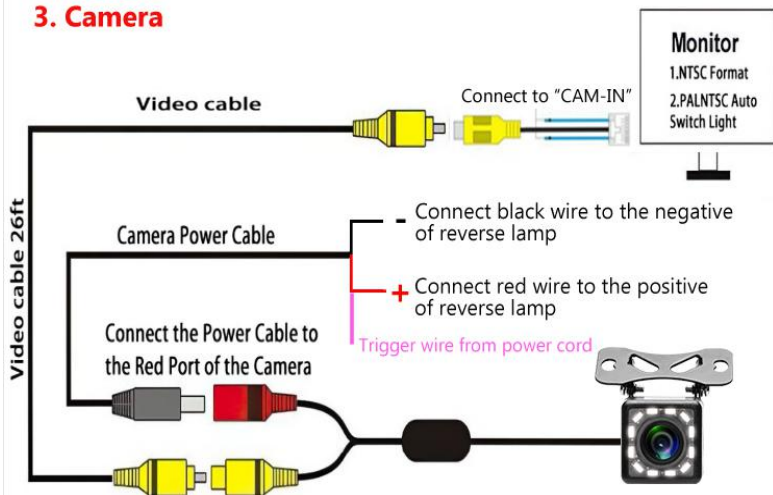

[Introduction of Basic Functions]

1. Main interface



The above are the interface diagrams of four different styles. The specific product interface is subject to the actual product you receive.

How to set wall paper:

You can long press the wallpaper until the indicator comes out to change it. Or you can have this section in photo viewing mode.

About the user interface (local music player and the small car), it cannot be changed.

If you don't like this home page, you can change it by installing an app named "agama", which allow you to add car logo and favorite apps on home page.

2. Main Menu Operation

- Touch the icon on the desired mode on screen and the unit will

then enter into the mode that selected for operation.

- Hold & slide the operation icon on screen to shift to other MAIN MENU that shows the hidden input or operation icons.

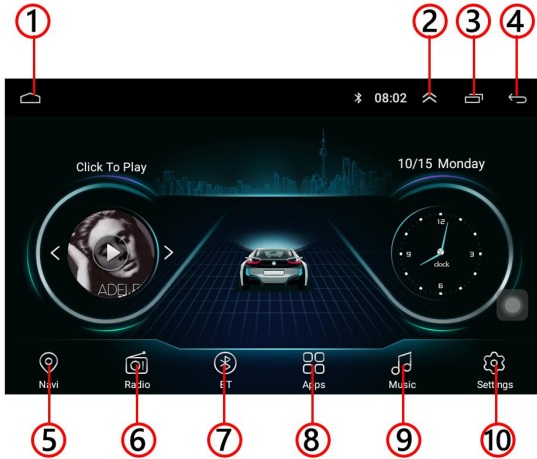

1.Touch to shift screen to MAIN MENU.

2.Touch to hide the shortcut menu button area. Touch the top and pull-down of the screen and wake up the shortcut menu button.

3.Touch to display all the programs running in the background, where you can choose to close the programs running in the background.

4.Touch to shift screen to return to the previous interface.

5.Touch to shift screen to navigation.

6.Touch to shift screen to Radio Operation.

7.Touch to shift screen to Blue Tooth Operation.

8.Touch to shift screen to the Icon Desktop of the installed app.

9.Touch to shift screen to Music Play Operation.

10.Touch to screen to start various System Settings of the unit.

3. System Settings

[Sound Settings]

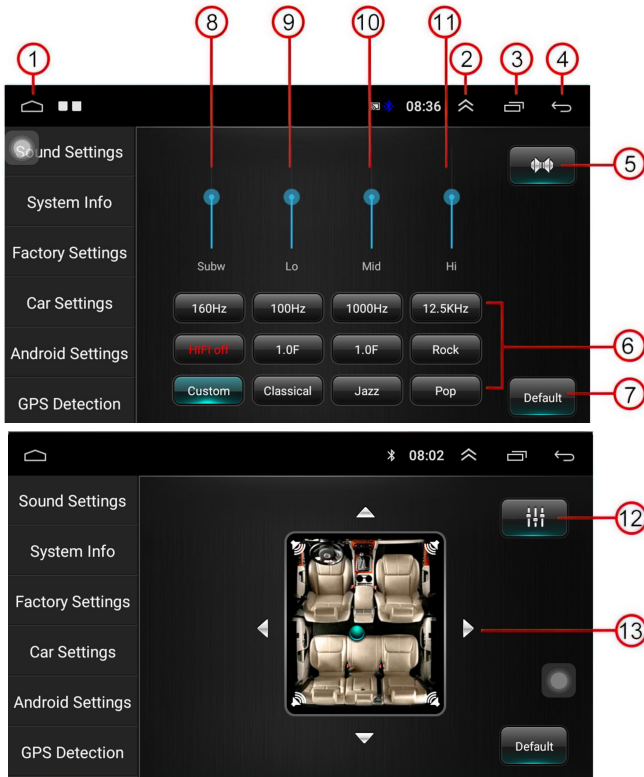

1.Touch to shift screen to MAIN MENU.

2.Touch to hide the shortcut menu button area. Touch the top and pull-down of the screen and wake up the shortcut menu button.

3.Touch to display all the programs running in the background, where you can choose to close the programs running in the background.

4.Touch to shift screen to return to the previous interface.

5.Touch to shift screen to SPEAKER MENU.

6.The user can select different system preset EQ modes and set different values.

8.With continuous touch and movement, you can set the value of the subwoofer to achieve the desired effect.

9.With continuous touch and movement, you can set the value of

the bass to achieve the desired effect.

10. With continuous touch and movement, you can set the value of the mid range to achieve the desired effect.

11. With continuous touch and movement, you can set the value of the treble to achieve the desired effect.

12. Touch to shift screen to EQ MENU.

13. Touch the front, rear, left and right arrows to decrease the volume output of the speaker corresponding to the mute. Or you can touch and drag the small ball on the screen to any position in the box to achieve the effect of setting the speaker.

[Factory settings]

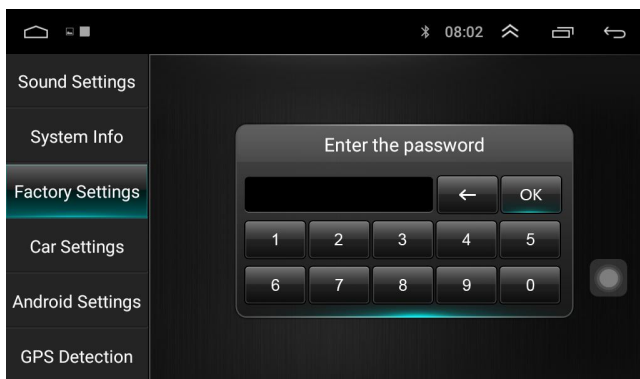

1. Enter the password to enter the Factory Settings. **The password is: 8888. (Different products, the password may be different)**

2. The Factory Setting interface is an option for important data of the system. Please set it carefully.

[Android Settings]

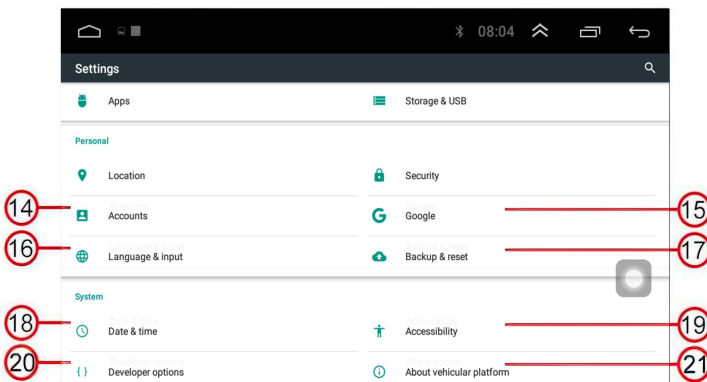
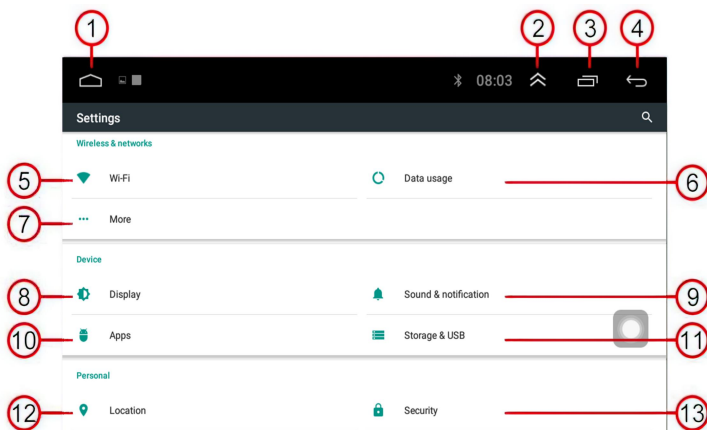

1.Touch to shift screen to MAIN MENU.

2.Touch to hide the shortcut menu button area. Touch the top and pull-down of the screen and wake up the shortcut menu button.

3.Touch to display all the programs running in the background, where you can choose to close the programs running in the background.

4.Touch to shift screen to return to the previous interface.

5.WIFI: Touch to open the WIFI connection interface, search for the WIFI name you need, then click on the connection.

6.Data usage: Touch to open the monitoring interface for data

usage. You can view the usage of data traffic in the corresponding date.

7.More: you can turn on or off the Airplane mode, setting Tethering & portable hot spot.

8.Display: Touch to open Display interface. You can setting the Wallpaper and Font size, Turn on or turn off the video output function of the machine.

9.Sound & notification: Touch to open Sound & notification interface. The user can set the alarm clock, the bell and the key tone of the system.

10.Apps: Touch to open Apps interface. You can separately view that all the apps that have been installed on the machine.

11.Storage & USB : Touch to open Storage & USB interface. You can see the total capacity and usage of built-in memory and the expanded memory

12.Location: Touch to get the current location information.

13.Security: Touch to set up security options for the system

14.Accounts: Touch to view or add user information.

15.Google: Touch to setting Google server information.

16.Language & input: Touch to set up language for the system, how many more the 40 languages to choose from. and you can also set up the system's input method on this page.

17.Backup & reset: Touch to shift screen to Backup & reset interface. You can perform the following actions on this page:

1>Back up my data: Back up app data, WIFI passwords and other settings to Google servers.

2>Backup account: Need to set the backup account.

3>Automatic restore: When rein stalling an app, restore backed to setting and data.

18.Date & time: Touch to open Date & time interface. In this interface, you can do the following:

1>Automatic date & time: You can set it to : Use met work-provided time I Use GPS -provided time/Off.

2>Set date: Touch to set the date, provided that Automatic date & time must be set to Off.

3>Set time: Touch to set the time, provided that Automatic date & time must be set to Off.

4>Select time zone: Touch to set the time zone.

5>Use 24-hour format: Touch to switch the time display format to 12-hour or 24-hour.

19.Accessibility: Touch to open Accessibility interface. Users can perform the following operations:

1>Captions: Users can turn on or turn off the captions, and setting Language, Text size, Caption style.

2>Magnification gestures: Users can turn on or turn off this operation.

3>Large text: Turn on this switch to make the font displayed on the screen larger.

4>High contrast text: Users can turn on or turn off this operation.

5>Touch & hold delay: Users can choose three modes: Short, Medium, Long.

6>Quick boot: Users can turn on or turn off this operation.

7>Color inversion: If turn on this switch, the background of the screen will turn black.

8>Color correction: Users can turn on or turn off this operation.

20.About vehicular platform: Display important information such as the system and version of the machine.

21.About the vehicle platform: Display important information, such as the machine's system and version.

[GPS detection]

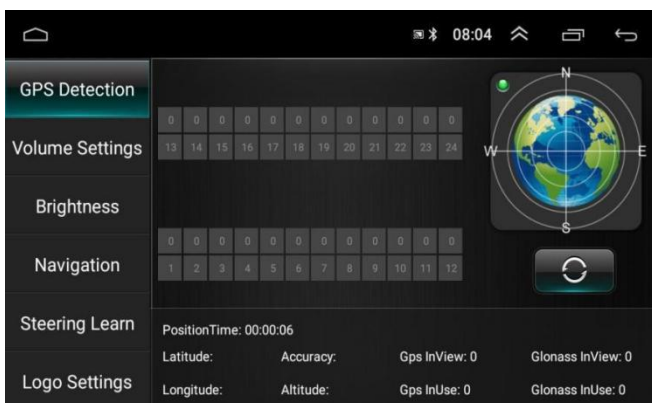

It is used to display the number of satellites currently positioned by GPS, the signal strength of the positioned satellites, and other information of the satellites.

[Volume setting]

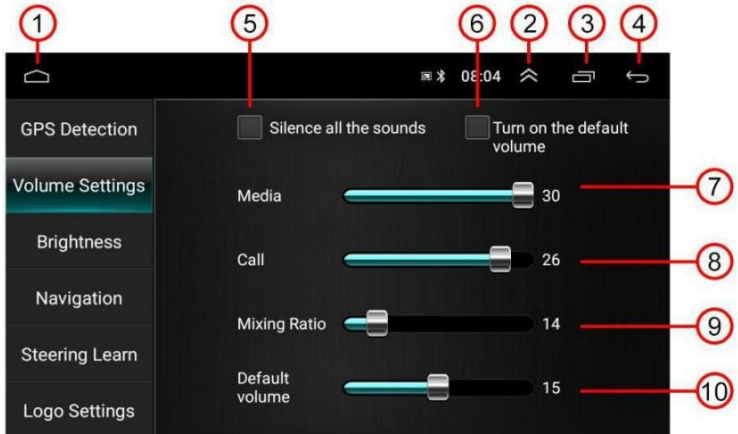

1.Touch to shift screen to MAIN MENU.

2.Touch to hide the shortcut menu button area. Touch the top and pull-down of the screen and wake up the shortcut menu button.

3.Touch to display all the programs running in the background, where you can choose to close the programs running in the background.

4.Touch to shift screen to return to the previous interface.

5.After touching the hook, the machine will silence all the sounds output.

6.After touching the hook, every time you turn on the machine, the volume will go back to the value set in Default volume.

7.Touch and drag to set the volume of the media.

8.Touch and drag to set the volume of the Call.

9.Touch and drag to set the Mixing Ratio of the sounds output

10.Touch and drag to set the Default volume of the sounds output,

[Brightness]

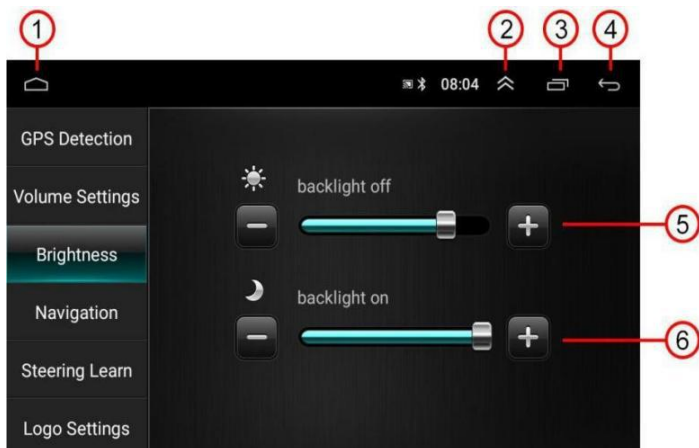

1.Touch to shift screen to MAIN MENU.

2.Touch to hide the shortcut menu button area. Touch the top and pull-down of the screen and wake up the shortcut menu button.

3.Touch to display all the programs running in the background, where you can choose to close the programs running in the background.

4.Touch to shift screen to return to the previous interface.

5.Connect the ILL line of the tail line of the machine to the positive pole of the headlamp of the car. When the headlamp is off, touch "+" or "-" to adjust the brightness of the machine backlight.

6.Connect the ILL line of the tail line of the machine to the positive pole of the headlamp of the car. When the headlamp is on, touch "+" or "-" to adjust the brightness of the machine backlight.

[Navigation]

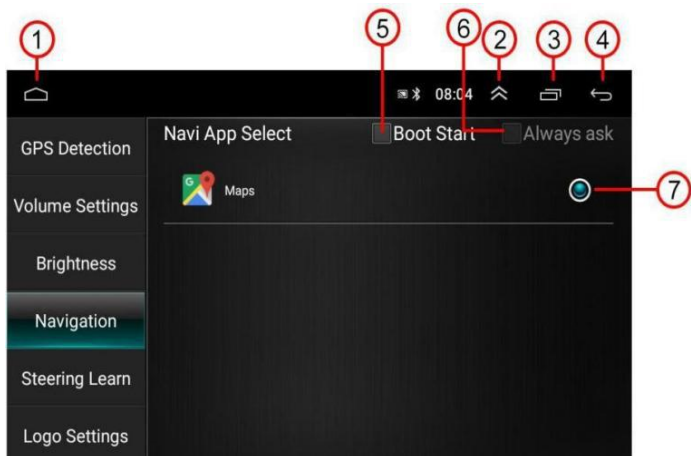

1.Touch to shift screen to MAIN MENU.

2.Touch to hide the shortcut menu button area. Touch the top and pull-down of the screen and wake up the shortcut menu button.

3.Touch to display all the programs running in the background, where you can choose to close the programs running in the background

4.Touch to shift screen to return to the previous interface.

5.After touching the hook, boot automatically run navigation.

6.If multiple navigation software is installed in the system, After touching the hook, the system will always ask which navigation software should be opened each time the navigation is started.

7.A list of navigation software installed in the system, the user can select one of the navigation software, when the navigation is turned on, the system will automatically run the navigation software.

[Steering wheel learning]



- 1.Touch to shift screen to MAIN MENU.
- 2.Touch to hide the shortcut menu button area. Touch the top and pull-down of the screen and wake up the shortcut menu button.
- 3.Touch to display all the programs running in the background, where you can choose to close the programs running in the background.
- 4.Touch to shift screen to return to the previous interface.
- 5.Touch to clear all learned steering wheel buttons.
- 6.List of steering wheel keys that can be used for learning.

How to connect steering wheel control lines:

Car's steering wheel control line may be 1-3 cables.

For 1 cable wiring, you choose either key1 or key2 to connect.

For 2 cables wiring :

If they are 1 positive and 1 negative - Positive connect either key1 or key2.Negative wire to the car radio's black wire (ground)

If they are two positive, you can connect both on key1 and key2

For 3 cables wiring, they should be 2 positive and 1 negative.

firstly choose one of the positive wire, connect it to the car radio's

wheel wire (either key1 or key2).

Test if it works (need to study button functions in setting - steering learn), and adjust according to the result it works on the buttons.

How to study the buttons on the steering wheel:

1. Connect the steering wheel control cables of this unit to the same cable as the car.

2. enter "setting - (slide the icon down to the left) - learn the steering"

3. Before studying, press the " reset " to clear the memory first.

4. Long press the steering wheel function icon on the radio, at the same time press the relevant button on the car steering wheel.

After successfully studying, induction comes. You can test the function of the button and study again if it fails.

[Other settings]

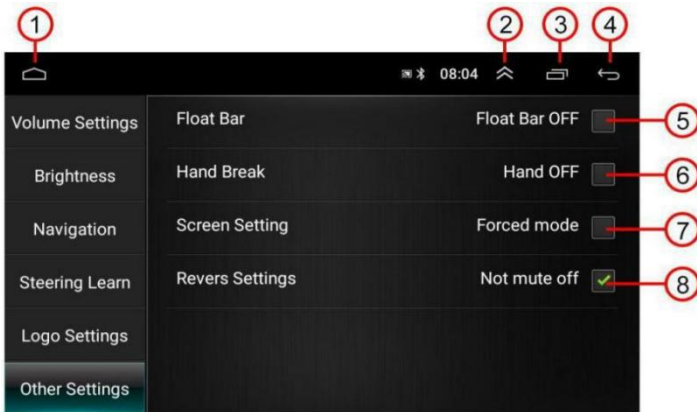

1.Touch to shift screen to MAIN MENU.

2.Touch to hide the shortcut menu button area. Touch the top and pull-down of the screen and wake up the shortcut menu button.

3.Touch to display all the programs running in the background, where you can choose to close the programs running in the background.

4.Touch to shift screen to return to the previous interface.

5.Float Bar: After touching the hook, Float Bar(Page) will appear on

the screen, you can click Float Bar to open the shortcut button.

6.Hand Break: Touch screen selection tick. When this switch is turned on, watching the video being played will not be allowed during the driving process. When this switch is turned off, you can watch the video in play at any time.

7. Screen setting: touch screen to select the mark. The machine screen display will be forced to display horizontally.

8. Reversing setting: The user can set whether the machine is in silent mode when reversing.

4. Bluetooth

Connection method: the machine power on, mobile phone open Bluetooth function, search equipment, the default Bluetooth name of the machine is: Car BT, after searching for the name, click on the paired connection, connection password: 0000/1234.

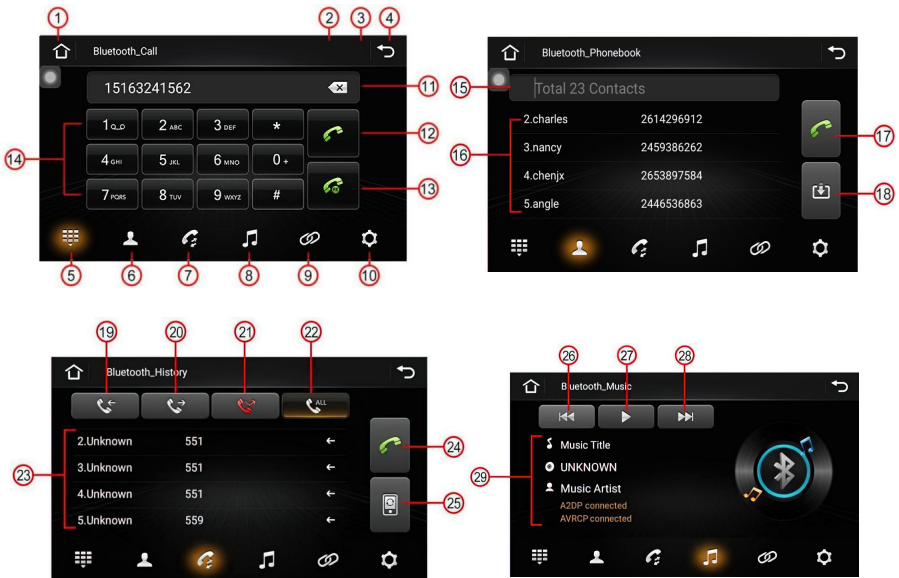

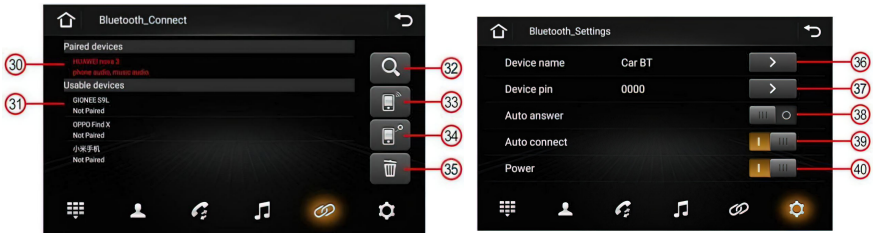

1.Touch to shift screen to MAIN MENU.

2.Touch to hide the shortcut menu button area. Touch the top and pull-down of the screen and wake up the shortcut menu button.

3.Touch to display all the programs running in the background, where you can choose to close the programs running in the background.

4.Touch to shift screen to return to the previous interface.

5.Touch to shift screen to BT CALL MEUN.

6.Touch to shift screen to BT PHONEBOOK MEUN.

7.Touch to shift screen to BT HISTORY MEUN.

8.Touch to shift screen to BT MUSIC MEUN.

9.Touch to shift screen to BT CONNECT MEUN.

10.Touch to shift screen to BT SETTINGS MEUN.

11.Phone number display area, number display area entered by numeric keypad.

12.Touch to dial the phone number of the current input area.

13.Touch to re-drawing the last dialed number.

14.Keyboard area for incoming telephone numbers.

15.Search contacts in the current address book.

16.List of downloaded address book displays.

17.Select a contact from the contact list and touch the button to dial the contact number.

18.Touch to download the address book of the currently connected cell phone.

19.Touch to view a list of all incoming phone numbers.

20.Touch to view a list of all phone numbers that have been dialed.

21.Touch to view a list of all unanswered phone numbers.

22.Touch to view a list of all call phone numbers.

23.Corresponding phone number list display area.

24. Select a contact from the contact list and touch the button to dial the contact number.

25. Touch to download all history for connected phones.

26. Touch to switch to the previous music playback.

27. Touch to pause music playback and touch again to resume playback.

28. Touch to switch to the next music playback.

29. The name and singer of the currently playing song,

30. Show phone name of paired connection.

31. Display the searched mobile phone.

32. Search for the mobile phone to be connected.

33. Connect Bluetooth.

34. Disconnect the Bluetooth connection.

35. Delete the Bluetooth device.

36. Device name: Touch to change the default Bluetooth device name. The default Bluetooth device name is: Car BT/Car kit.

37. Device PIN: Touch to change the default Bluetooth device PIN. The default Bluetooth device name is: 0000/1234.

38. Auto answer: Touch to turn on or turn off the Auto answer operation. When this operation is turned on, and the phone calls in, the phone will be automatically answered.

39. Auto connect: Touch to turn on or turn off the Auto connect operation. When this operation is turned on, and the device is disconnected, the previously connected mobile will be automatically connected to the device within the range of distance. When this function is closed, each device needs to be manually connected after disconnection.

40. Power: Touch to turn on or turn off the BT Power. When BT Power is turned off, the phone will not be able to search for the Bluetooth device.

5. Local Music

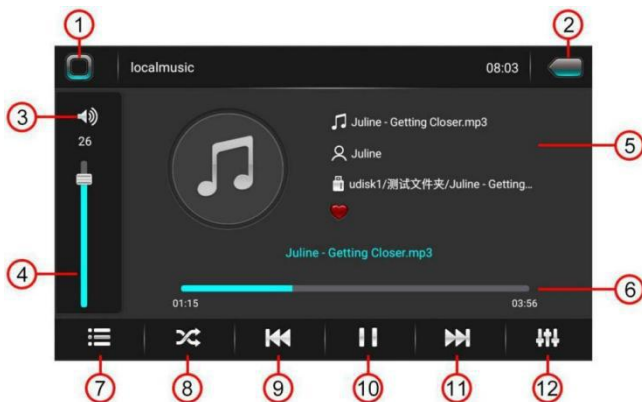

6. Local Radio



7. Net Navi

Touch to open GPS navigation, the system will ask to select multiple navigation software installed, or automatically launch the default navigation software that has been set.

8. Video

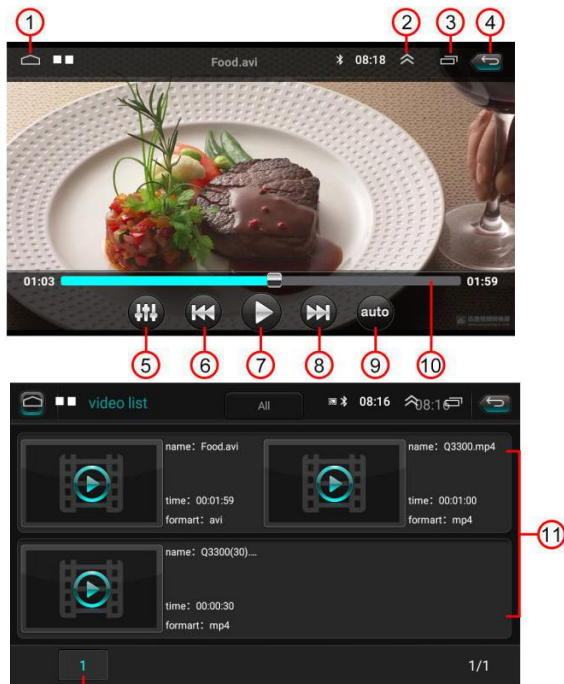

9. TIMA

(Note: Please refer to the APP corresponding to the actual product)



- 1.Touch to exit the program.
- 2.Touch to switch the screen to the Android USB mobile phone interconnection interface
- 3.Touch to switch the screen to the Android wireless mobile phone interconnection interface.
- 4.Touch to switch the screen to the Apple wireless mobile phone interconnection interface.
- 5.Touch to display information about the software.
- 6.Click to enter the file transfer interface.
- 7.Tap to open the QR code, and then scan the QR code on the phone to download the TIMA APP.

10. ANDROID LINK menu

Use a USB cable to connect to your mobile phone, or mobile hot spot/WiFi (Android phone required)

Open the developer option on the phone, enter the developer option, and then turn on USB debugging.

Open the TIMA application and follow the prompts on the phone to complete the connection.

Note: If you do not find the developer option in the phone settings, please go to About phone and click the version number 7 times in a row. The system will prompt you: You are already in developer mode.

11. IPHONELINK menu

- 1.Open mobile phone hot spot and select your hot spot in the list.
- 2.Slide up your iPhone, click the Air Play mirror.
- 3.Scan QR code and Download TIMAAPP, install TIMAAPP.

12. Screen floating bar

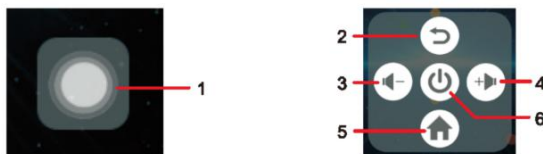

Go to the settings interface, other settings, find the Float Bar and choose to tick.

1.Float Bar can appear in any interface, touch to open the shortcut menu.

2.Touch to shift screen to return to the previous interface.

3.Touch to reduce the volume.

4.Touch to increase the volume.

5.Touch to shift screen to MAIN MENU.

6.Touch to shutdown the machine.

13. Panel button control light

1.Turn on the settings.

2.Open the factory settings and enter the password, the password is: 8888 (different products, different passwords).

3.Find the button light setting to adjust, or connect the orange ILL wire to the positive wire.

14. Offline Map

In order to use the offline function of the device, please follow below steps for setup.

1.Power on the unit and connect the device to internet by Wifi.

2.Find the APP named Here in the main menu.

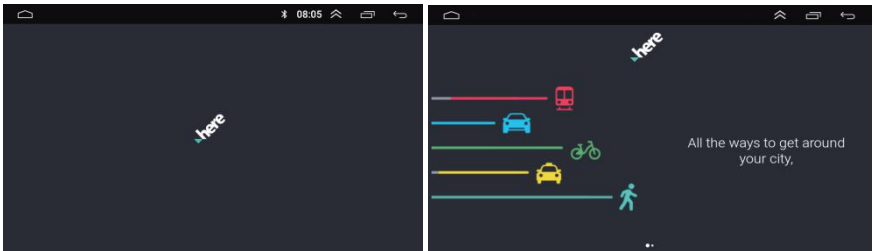

3.Follow the tips of the app to the main map page and find the option menu.

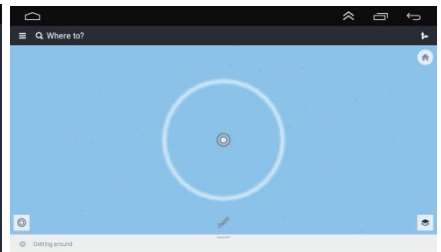

4. Click "Use app offline" and download your preferred map data in the country list.

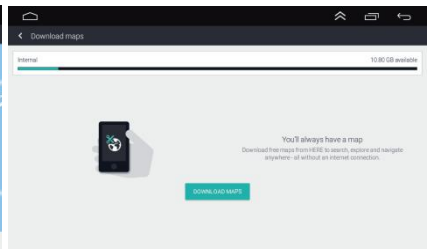
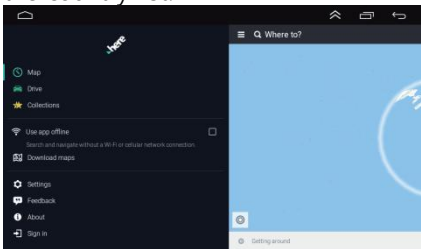

[Simple Trouble Shooting]

PROBLEMS, CAUSE & SOLUTIONS

1>Unable to boot normally

Please check the following points:

1. Please confirm the power source is DC 12V.
2. Please only use the power wires coming with the radio.
3. Check if you connect all power cables wiring:

(1) red wire connect to ignition switch (ACC)

(2) yellow wire connect to battery positive

(3) black wire connect to battery negative

(4) power port is tightly inserted

4. Check if the fuse is good. Replace with the proper value fuse if necessary.

If all the above has no problem, please do a test as the following steps:

1. Disconnect all other wires of the radio

2. Only connect the red wire and yellow wire directly to DC 12V battery positive, and the black cable to negative.

3. Check if it has the same problem.

Thus, you can confirm it is the device matter or the car wire matter.

2>Automatic shut-down

Automatic shutdown usually has these following conditions

1. The cable error connect: If the blue cable (automatic antenna power) is connected to the power cable of the unit, an automatic shutdown will occur. Please follow the correct wiring method to solve the problem.

2. The voltage is unstable: Please find a 12V-5A power supply and retest to see if it automatically shuts down. If it does not automatically shut down after the test, please replace the power supply. If it will automatically shut down, it is problem with the unit.

3>When booting up, only the Android logo is displayed and it is stuck and cannot be used.

Please confirm power cable and fuse connection firstly, see if it is loose, then confirm the battery voltage is stable between 10V-16V.

If they are all good, it is the software issue.

Please send one photo of the system version in Setting - System information, another photo of the paper label stucked on car radio's backside, then I can confirm the producing factory and version, for further assistance.

4>Noise

-Noise is generally caused by two reasons

1.The original speaker power is too small. When the volume of the unit is turned up, there is a noise.

Solution: When changing speakers or listening to songs, the volume should not be too loud.

2.The speaker cable is grounded.

Solution: Remove the grounded speaker cable. It can be directly connected to the speaker wire of the machine.

5>The equalizer is set, the sound cannot be adjusted

-Adjust the sound: please turn the volume button to adjust.

-Equalizer settings: Normally, press the volume knob to display the equalizer SEL, then rotate the volume buttons to adjust each sound effect.

- The sound cannot be adjusted:

1.Please reset the unit or unplug the power cord and plug it in again.

2.The "Volume" knob is damaged and can be replaced.

6>No sound after installation

-Dear customer, this product has been tested before leaving the factory. If there is no sound, it is usually a wiring error or the original car speaker wire is shorted by the iron. Please follow the steps to check.

1.Check the speaker cable for shorts. If shorted, reconnect.

2. Please check how many speaker cables the original speaker has, if there are only two speaker cables, it proves that the original car wiring does not match our equipment, you need to rearrange the original car wiring, 1 speaker must be connected with 2 speaker wires. 2 speakers must have 4 speaker cables available.

7>After a while there is no sound

- Disconnect all speaker cables from this unit (please don't disconnect other wires) and find an external speaker to connect the unit's gray and purple power wires. Then try to see if there is any sound.

If there is a sound, it proves that the car's speaker line is shorted by iron or the speaker is damaged. If there is no sound, the unit is damaged.

8>The sound of the car's microphone is very small, and the other party can't hear the Bluetooth call

Have you tried these solutions?

(1) Clean the dust in the microphone hole "MIC"

(2) Set the car radio volume in setting - audio/volume setting - Bluetooth volume. And set it in phone Bluetooth volume.

(3) Delete Bluetooth connection record in both car radio and your phone. and pair again.

(4) Test with another mobile phone to see if it is compatibility issue.

(5) You can try to install an online radio app named "Bluetooth auto connect" to replace the preload Bluetooth app

(6) Reset the unit

9>Only the radio has sound, other modes (Bluetooth, USB) have no sound

Please confirm you the subwoofer or amplifier power cable connection.

1. If there are three power cables, "+", "-" and "REM", wiring:

"+" - battery positive

"-" - battery negative

"REM" - car ignition switch

2.If there are two power cables, "+" and "-", wiring:

"+" - car ignition switch

"-" - battery negative

3.Also note that the wire "ANT CONTROL" or "AMP control" don't need to connect.

4.Thus, when your car is on, subwoofer will turn on for all audio mode, not only for radio mode.

10>BT call the other party can hear the sound, but I can't hear

Firstly, please confirm if other audio modes can work well.For different modes may has different problem. Modes includes: Bluetooth phone call, Bluetooth music, AUX, media audio (apps), FM radio.

You can test Bluetooth music firstly, because they share the same audio channel (hardware)

Bluetooth phone call audio comes out only from front speakers.

Bluetooth music audio come out from all four speakers.

Possible result and solution:

1. BT phone call no sound, but BT music sound good

-Check if you choose output mode on phone as Bluetooth, instead of phone/earphone, in phone call interface

-Check Bluetooth volume is raised enough (set on phone, and on car radio "Setting - volume setting - Bluetooth volume")

-Check front speakers cables connection and if they are good

2. Both BT phone call and music has no sound, at the same time, app audio has no sound. But FM radio sound good.

-Hardware defective, audio channel broken. Please contact us by seller center

11>Bluetooth not working

- Check if your phone can search for Bluetooth codes.

-Operation steps: turn on the device, use the mobile phone Bluetooth to search, search for CAR-MP5 or car Bluetooth name, then click connect, after connecting, you can answer the call or Bluetooth to play songs.

PIN code: 0000/1234

12>Navigation APP can not be accessed, no sound, screen delay, inaccurate positioning, stuck and cannot be used, etc.

If the above issue occurs, you will need to follow these steps to troubleshoot:

First, you need to confirm whether it is a wiring problem. Please check your wiring, check whether the interface is damaged, whether the wiring is wrong, etc. If yes, please reconnect according to the correct wiring method. If there is no problem with the wiring, the GPS antenna may be damaged.

Second, you need to determine if it's a procedural problem. If your Google Online Navigation APP cannot be accessed, etc., there is a problem with your program. Please find the product information (you can view the product information in the settings interface) and tell the customer service staff, they will tell you how to upgrade the software.

Finally, if you use offline maps, please uninstall the original offline map software, and ask the customer service staff to obtain the universal map APK software. (This APK takes up very little memory, don't worry about taking up space)

13> FM can't find radio

- There are two situations in which the radio station cannot be searched:

1.The antenna plug is not fully inserted, the antenna is disconnected or the line is disconnected.

2.Search for channels, press and hold AMS for 2 seconds. The unit will automatically search or press the up and down buttons to perform channel search. After trying the above two points, still can't solve it, please unplug the antenna and find a screwdriver or metal strip to insert it instead of the antenna.

14>Does not support reversing image

-Generally two situations

1.Connect the wrong line or less wiring. Camera connection method:
a>The first step is to find accessories (accessory: one camera+ one power cord+ one video cable).

b>The second step is to find the port of the wiring.First find the reversing control line on the power line of the unit. The control line is a pink line or brown line, connect this line to the positive pole of 12V and the screen will turn blue. Find the back of the unit the CAME video input interface, find the positive and negative of the backup light.

c>The third step is to connect:There are two sockets on the camera,the red socket is connected to the power cord, the yellow one is plugged into the video cable,the red power cable and the video cable are screwed together and connected to the positive pole of the reversing light, and do not use the black wire to connect,connect the other end of the video cable to the CAME video input on the back of the device.The red wire coming out of the video cable is connected to the reverse control wire of the power cable.

2.Camera is broken. If the infrared light of the camera does not light up after the correct connection, the camera is damaged, please replace it with a new one.

15>GPS, Voice, Language, Offline Maps only in English and Chinese

About the GPS voice, the Here WeGo map only has English and Chinese voice, because from our version we only have English and Chinese.

You can use other online navigation app to get other language voice, or download from other map app.

16>The button light does not light up

1.About the keypad light, please confirm the "ILL" cable is well connected to your car's head light positive. This cable will trigger on the keypad light when your head light is on.

2.Brightness mode can be set in setting- Factory setting (password 8888) - Key light setting - tick all three options below

17>Clock still showing after shutdown

The clock function is a product fixed function and cannot be deleted. In fact, the product is turned off, which does not drain the car's power.

18>Remove the original car's radio

The best way is to do it yourself. If you can't, you can ask customer service to help you.

19>Unable to save settings (No memory)

- There is no memory function for the following two reasons

1.The yellow wire and the red wire are connected together (Yellow should be connected to the positive pole, red should be connected to the button control)

2.The yellow and red connections are reversed (The wiring position should be replaced)

20>How to turn off PODOFO+ little robot Floating Icon

- First, please open the PODOFO Voice software

- Swipe down the interface to find Floating Icon

- Click to close the floating icon

21>Install the Navigation antenna

First, you should tighten the screws of the navigation antenna and device. Then you have to fix the navigation antenna module in a sunny place or on the windshield (this is important because improper installation will affect the navigation signal)

22>USB flash drive does not read (Optional)

- The reading of USB flash drives and memory cards has been tested before leaving the factory. Please do not doubt this machine lightly.

First format the memory card or USB flash drive on your computer, then download it again and see if it reads.

If it doesn't read, try changing your memory card or USB flash drive.

If it still cannot be connected, please check whether the USB interface is loose or damaged.

If it still cannot be read, please contact the after-sales customer service staff directly.

23>The product emits smoke

-The smoke from the product proves that the internal circuit has been burned, and replacing the fuse cannot solve the problem

- In this case, the unit needs to be replaced, please contact us.

24>Machine reset

1.When using the system for the first time before or after replacing the battery, the machine must be reset.

2.When the machine does not function properly, the machine must be reset

3.In the system setting interface, click restore to factory settings to make the machine in the initial state.

4.Using a sharp object, press the RESET button on the panel, the machine will be reset and turned off, returning to the factory initial state

NOTE: By pressing the RESET button, system initialization will lose the time and previously set values.

25>Steering wheel button learning

Connect the KEY and KEY2 on the machine's power cord plug to the original car's steering wheel control wires. After touching the button icon on the screen, quickly find the corresponding function button on the steering wheel of the original car, then press the button until the machine screen prompts that the set up is successful, then release it!You can learn the next button.



26>Screen button light is on, but the screen black

1. Check if the machine is doing this at the beginning or after a while
2. If the machine is used for a period of time, then confirm whether the connection is loose, if the connection is OK, then the machine is burned out
3. Confirm whether the machine is powered up normally, whether the button light will light up
4. Light screen does not light up, confirm whether the screen line is loose
5. Check if the power cable and the automatic antenna/light cable are connected backwards

27>Touch screen and button not work

1: Five-finger correction screen

Press and hold the screen with five fingers at the same time, four dots will pop up, follow the prompts, click.

2: Button calibration: click the [car setting]-[factory setting]-input code 8888-Touch settings-click"start", first click interface button, then click the corresponding touch keys on the left side, after learning tap end, please click "close" to finish buttons Calibration.

3: Check the screen inner wire

You can unplug the screen wire, find there are several screen wire, Pull out and insert again.

4: Please try to poke"RES" hole to reset.